

Joint Annual Meeting 2014

Swiss Headache Society SHS

Swiss Society for Sleep Research, Sleep Medicine
and Chronobiology SSSSC

May 15–16, 2014

Verkehrshaus Luzern, Switzerland

www.imk.ch/skg2014



Schweizerische Kopfwehgesellschaft
Société suisse pour l'étude des céphalées
Società svizzera per lo studio delle cefalee
Societat svizra per il studi del mal il tgau
Swiss Headache Society



Schweizerische Gesellschaft für Schlafforschung, Schlafmedizin und
Chronobiologie
Société Suisse de Recherche sur le Sommeil, de Médecine du
Sommeil et de Chronobiologie

Program



Freie Auswahl: Orange oder Grapefruit, beide zuckerfrei.

Beide kassenpflichtig

- ✓ Hoch dosiert
- ✓ Sehr gute Resorption¹
- ✓ Gut im Geschmack

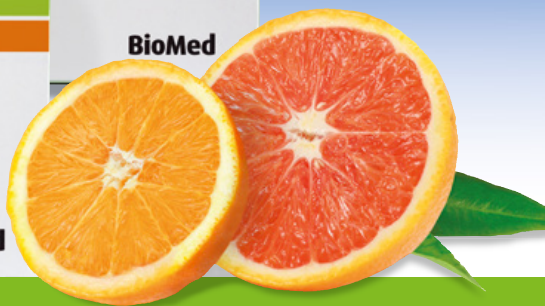

BioMed®

Biomed AG CH-8600 Dübendorf
Tel +41 (0)44 802 16 16
Fax +41 (0)44 802 16 00
biomed@biomed.ch
www.biomed.ch

Gekürzte Fachinformation Magnesiocard® (Magnesiumpräparat). **Indikationen:** Magnesiummangel, Herzrhythmusstörungen, erhöhter Bedarf im Hochleistungssport und während Schwangerschaft, bei Eklampsie und Präeklampsie, tetanischem Syndrom und Wadenkrämpfen. **Dosierung:** 10-20 mmol täglich, entsprechend der Darreichungsform (Granulat, Brausetabletten, Tabletten) aufgeteilt in 1-3 orale Einzeldosen. **Anwendungseinschränkungen:** Eingeschränkte Nierenfunktion. Die gleichzeitige Verabreichung mit Tetracyklinen ist zu vermeiden. **Unerwünschte Wirkungen:** Als Folge hochdosierter oraler Magnesiumtherapie können weiche Stühle auftreten. **Packungen:** Tabletten (2,5 mmol) 50, 100; Granulat (5 mmol) Citron und Granulat (5 mmol) Orange 20*, 50, 500; Brausetabletten (7,5 mmol) 20*, 60; Granulat (10 mmol) Grapefruit und Granulat (10 mmol) Orange 20*, 50*, Ampullen i.v. (10 ml) 10; Verkaufskategorie B. Ausführliche Angaben siehe www.swissmedicinfo.ch oder www.compendium.ch. © 2013 Biomed AG. All rights reserved. ¹Classen, H.G. et al. Vergleichende tierexperimentelle Untersuchungen über die Resorption von Magnesium als Sulfat, Chlorid, Aspartat und Aspartat-Hydrochlorid aus dem Magen-Darm-Trakt. *Arzneim.-Forsch.*, 23, 267-271, 1973. *kassenpflichtig

Contents

Welcome	4
General information	5-10
Partners and exhibitors Hall overview	7
Technical information	8
Travel information	9
Social Evening	10
Program	
Thursday 15.05.2014	11-13
Friday 16.05.2014	14-18
List of invited speakers and chairs	19-20
Posters	21-22

Online registration:
www.imk.ch/skg2014

Welcome

Dear colleagues

This year's Joint Annual Meeting from May 15-16, 2014 will bring together the Swiss Headache Society (SHS) and the Swiss Society for Sleep Research, Sleep Medicine and Chronobiology (SSSSC). This cooperation creates a new source of scientific potential and provides insights into the scientific domain and clinical interrelations of sleep and headache. The interdisciplinary scientific program includes a wide range of workshops and lectures on neurobiology, genetics, rhythms, cognition and inflammation. We are pleased to announce several national and international highly qualified speakers who will deliver insights into the above mentioned subjects.

Moreover we are delighted that our Joint Annual Meeting will be held in Lucerne. The landmarks of the city namely the lake and the mountains and its location in Central Switzerland is hoped to facilitate the exchange of information and ideas.

On behalf of the scientific committee, it is a great pleasure to invite you to the Joint Annual Meeting 2014 of the Swiss Headache Society and the Swiss Society for Sleep Research, Sleep Medicine and Chronobiology.

We are looking forward to a fruitful and inspiring congress and welcome you to Lucerne!



PD Peter Sandor, MD
President SHS



Prof. Peter Achermann, PhD
President SSSSC

General information

- Date Thursday to Friday, May 15-16, 2014
- Venue Verkehrshaus Luzern
Lidostrasse 5
6006 Lucerne, CH
www.verkehrshaus.ch
- Congress website www.imk.ch/skg2014
- Websites of the societies www.headache.ch
www.swiss-sleep.ch
- Presidents SHS | PD Peter Sandor, MD; Baden
SSSSC | Prof. Peter Achermann, PhD; Zurich
- Scientific Committee SHS
Andreas Gantenbein, MD; Bad Zurzach
Claudio Gobbi, MD; Lugano
Peter Myers, MD, Geneva
PD Peter Sandor, MD; Baden
Prof. Till Sprenger, MD; Basel
Prof. Mathias Sturzenegger, MD; Bern
- SSSSC
PD Christian Baumann, MD; Zurich
Katerina Espa Cervena, MD; Geneva
Prof. Paul Franken, PhD; Lausanne
Yvonne Nussbaumer, MD; Münsterlingen
Prof. Björn Rasch, PhD; Fribourg
José Haba-Rubio, MD; Lausanne

Administrative
secretariat

IMK

Institut für Medizin und Kommunikation AG
Institut pour la médecine et la communication SA
Institute for medicine and communication Ltd

Münsterberg 1, CH-4001 Basel
Tel: +41 61 271 35 51 | Fax: +41 61 271 33 38
congress@imk.ch | www.imk.ch

General information

Registration Registration online via congress website www.imk.ch/skg2014 for your participation in the congress and the social evening.

Congress fees (CHF)	Early bird until March 31	Regular from April 1 to May 13	Onsite from May 14
Members SHS, SSSSC	200	250	300
Non-members physicians	300	350	400
Assistants, nurses	140	170	200
Students	90	120	150

Cancellation policy **IMK** must be informed about the cancellations in written form until March 31, 2014. We will be able to reimburse 50% of the congress fees. After March 31, 2014 no refunds will be made.

Confirmation of participation Participants will receive a confirmation of attendance at the congress secretariat.

Credits

- Swiss Neurological Society SNS: 13
- Swiss Society for Sleep Research, Sleep Medicine & Chronobiology SSSSC: 13

Congress language The official congress language is English. However speakers can opt for German or French if preferred. Slides have to be in English.

Opening hours
congress secretariat Thursday, May 15, 2014: 09:00–18:00 h
Friday, May 16, 2014: 07:30–16:30 h

Meetings

- SHS General assembly
Thursday May 15, 2014, 17:30–19:00 h, Room DC3/Orion
- SSSSC General assembly
Thursday May 15, 2014, 17:30–19:00 h, Coronado

Partners and exhibitors | Hall overview

Premium Partner
SHS 2014



Partner SHS 2014



Supporter SHS 2014



Sponsor



Exhibitors

PanGas AG
Pfizer AG
Philips Respironics
Pro Farma AG
ResMed Schweiz AG

Opening hours
industrial exhibition

Thursday, May 15, 2014: 09:30–17:30 h
Friday, May 16, 2014: 08:00–15:00 h

Hall overview

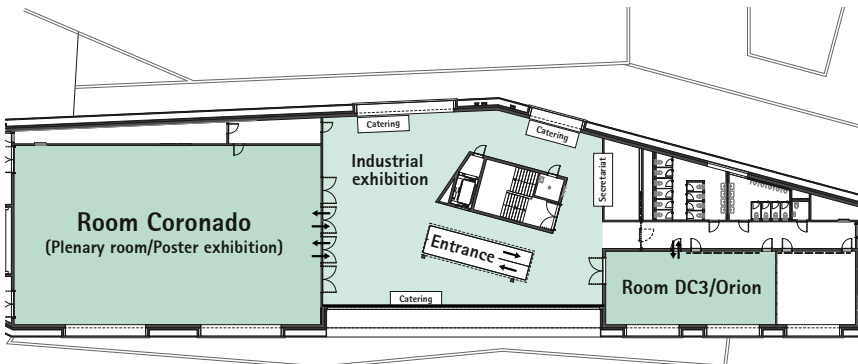

Technical information

- Technical equipments in the lecture halls** The lecture halls are equipped with a beamer and a computer. We ask the speakers to save their presentation on a USB stick and deliver it to the organizers in the break before the session.
- Free Communications** Friday, 16.05.2014, 10:30-12:00 h
The talk time for Free Communications is 7 minutes followed by 3 minutes of discussion. Please refer to the scientific program for the time of your presentation. The quality of the submitted abstract, the presentation and the slides will be considered for the best abstract and best oral presentation awards respectively.
- Poster exhibition** Posterboards in the format 200cm x 100cm (height x width) will be at your disposal. Hang-up of the posters: Thursday, 15.05.2014 from 09:00-12:30 h in the poster exhibition in the Room Coronado. Posterviewing: Friday, May 16, 2014 from 12:30-13:30 h. The authors are requested to be present at their posters during this time. The posters will be rated by experts of the scientific committee.
- Awards** SHS
Hans Ruedi Isler Research Fellowship 2014
Best abstract
- SSSSC
Sponsors Award for Outstanding Clinical and Basic Sleep Research 2014
Award for the best oral presentation and for the best poster
- Abstract authors are asked to be present at the award ceremony:
Friday, May 16, 2014, 16:30-17:15 h, Room Coronado.
- Abstract publication** Accepted abstracts will be published in the following journals:
SHS: Nervenheilkunde
SSSSC: SSSSC website

Travel information

Verkehrshaus Luzern | Lidostrasse 5, 6006 Lucerne | www.verkehrshaus.ch



Way from the train station in Lucerne

8 minutes by train

Train S3 or Voralpenexpress to the stop "Luzern Verkehrshaus"

Schedule: www.sbb.ch

10 minutes by bus

Bus Nr. 6, 8 or 24 to the stop "Verkehrshaus"

Schedule: www.vbl.ch

10 minutes by boat

Own landing stage "Verkehrshaus-Lido"

Schedule: www.lakelucerne.ch



Social Evening

Hospitality and tradition, atmosphere and pleasure are united in the legendary Hotel Seeburg. It is not only the oldest hotel at Lake Lucerne, but an impressive destination offering exclusive comfort, well-being and a unique view of the lake and mountains. The Seeburg Room – with a spectacular view over the lake and the mountains – unites the rich tradition of the Seeburg with contemporary architecture. In the open-air Sunset Bar one can enjoy an aperitif first.

Hotel Seeburg Luzern

Seeburgstrasse 53-61, 6006 Lucerne

www.hotelseeburg.ch

Thursday, May 15, 2014, from 19:30 h

Dinner tickets can be purchased while registering for the congress.

Physicians: CHF 100.- per person

Assistants | Nurses | Students: CHF 50.- per person



Schedule | Thursday, May 15, 2014

	Room Coronado	Room DC3/Orion	Room Coronado	
10:00 - 10:30	1 Neurobiology of headache	2 Neurobiology of sleep		
10:30 - 11:00	WS 12	WS 12		
11:00 - 11:30	Coffee break			
11:30 - 12:00	3 Neurobiology of headache	4 Neurobiology of sleep		
12:00 - 12:30	WS 12	WS 12		
12:30 - 13:15	Lunch		Poster exhibition	
13:15 - 13:30	Welcome			
13:30 - 14:00	Interrelations between sleep and headache			
14:00 - 14:30				
14:30 - 15:00		12		
15:00 - 15:30	Coffee break			
15:30 - 16:00	Posttraumatic sleep, headache, stress disorders			
16:00 - 16:30				
16:30 - 17:00		13		
17:00 - 17:30				
17:30 - 18:00	General assembly SSSC	General assembly SHS		
18:00 - 18:30				
18:30 - 19:00				
from 19:30	Social Evening at Hotel Seeburg Luzern			

 Meeting

10:00–11:00

Room Coronado

WS
1

Neurobiology of headache

Chair: Peter Sandor, Baden

Jean Schoenen, Liège; BE

10:00–11:00

Room DC3/Orion

WS
2

Neurobiology of sleep

Chair: Christian Baumann, Zurich

Thomas E. Scammell, Boston; US

11:00–11:30

Coffee break

11:30–12:30

Room Coronado

WS
3

Neurobiology of headache

Chair: Peter Sandor, Baden

Jean Schoenen, Liège; BE

11:30–12:30

Room DC3/Orion

WS
4

Neurobiology of sleep

Chair: Christian Baumann, Zurich

Thomas E. Scammell, Boston; US

12:30–13:15

Lunch

13:15–13:30

Room Coronado

Welcome

Peter Sandor, President SHS; Peter Achermann, President SSSSC

13:30–15:00

Room Coronado

Interrelations between sleep and headache (sleep apnea)

Chairs: Yvonne Nussbaumer, Münsterlingen; Ramin Khatami, Barmelweid

13:30–14:00

Insomnia and headache, an ominous combination at altitude

Konrad E. Bloch, Zurich

14:00–14:30

Cluster headache and sleep apnea

Mads Barløse, Glostrup; DK

14:30–15:00

Relationship between migraine/tension headache and sleep apnea

Philipp Valko, Zurich

15:00–15:30

Coffee break

Scientific program | Thursday, May 15, 2014

15:30-17:00

Room Coronado

Posttraumatic sleep, headache, stress disorders

Chairs: Andreas Gantenbein, Bad Zurzach; Christian Baumann, Zurich

15:30-16:00

Posttraumatic sleep-wake disorders

Christian Baumann, Zurich

16:00-16:30

Posttraumatic headache disorders

Andreas Gantenbein, Bad Zurzach

16:30-17:00

Posttraumatic stress disorders

Josef Jenewein, Zurich

17:30-19:00

Room Coronado



General Assembly SSSC

17:30-19:00

Room DC3/Orion



General Assembly SHS

from 19:30

Social evening at Hotel Seeburg Luzern

Schedule | Friday, May 16, 2014

	Room Coronado	Room DC3/Orion	Room Coronado
08:30 - 09:00	Rhythms in sleep and headache 15	Genetics of sleep and headache 15	Poster exhibition
09:00 - 09:30			
09:30 - 10:00			
10:00 - 10:30	Coffee break		
10:30 - 11:00	Free Communications SHS SSSSC 16	Free Communications SSSSC 17	
11:00 - 11:30			
11:30 - 12:00			
12:00 - 12:30	Lunch		Posterviewing
12:30 - 13:00			
13:00 - 13:30		Electrical Stimulation in Obstructive Sleep Apnoea 18	Poster exhibition
13:30 - 13:45			
13:45 - 14:00		How to score respiratory polygraphies? 18	
14:00 - 14:30			
14:30 - 15:00	Coffee break		
15:00 - 15:30	Sleep and cognition 18	Inflammation in sleep and headache 18	
15:30 - 16:00			
16:00 - 16:30			
16:30 - 17:00	Award ceremony 18		
17:00 - 17:15			

08:30–10:00

Room Coronado

Rhythms in sleep and headache

Chairs: Peter Myers, Geneva; Paul Franken, Lausanne

08:30–09:00

Rhythms; cluster headache

Philip Holland, London; GB

09:00–09:30

Rev-Erb α and adult hippocampal neurogenesis

Urs Albrecht, Fribourg

09:30–10:00

Ca v 3 calcium channels in sleep rhythms and brain plasticity

Anita Lüthi, Lausanne

08:30–10:00

Room DC3/Orion

Genetics of sleep and headache

Chairs: Till Sprenger, Basel; José Haba-Rubio, Lausanne

08:30–09:15

Current developments in headache genetics

Tobias Freilinger, Tübingen; DE

09:15–10:00

Current developments in sleep genetics

Mehdi Tafti, Lausanne

10:00–10:30

Coffee break

10:30–12:00

Room Coronado

Free Communications SHS | SSSSC

(detailed program see page 16)

10:30–12:00

Room DC3/Orion

Free Communications SSSSC

(detailed program see page 17)

12:00–13:00

Lunch

10:30–12:00

Room Coronado

Free Communications SHS | SSSSC

Chairs: Till Sprenger, Basel; Johannes Mathis, Bern

10:30–10:40

Multi-Center 3T MRI Study of Thalamic Morphology in Migraine using Label-Fusion-Based Segmentation and Deformation Based Morphometric Surface Analysis

S. Magon, A. May, A. Stankewitz, P.J. Goadsby, A.R. Tso, M. Ashina, F.M. Amin, C. Seifert, M.M. Chakravarty, J. Müller, T. Sprenger; Basel (CH), Munich (DE), San Francisco (US), Copenhagen (DK), Hamburg (DE), Toronto (CA)

10:40–10:50

The roots and the branches of the trigeminal nerve

J. Kamtchum Tatuene, M. Becker, A. Kleinschmidt; Geneva (CH)

10:50–11:00

Decrease of Grey Matter Volume in the Periaqueductal Grey is Associated with Treatment Response in Medication-overuse Headache

F. Riederer, A.R. Gantenbein, M. Marti, R. Luechinger, S. Kollias, P.S. Sándor; Zurich (CH); Vienna (AT), Bad Zurzach

11:00–11:10

Effects of increasing botox, i.e. onabotulinum toxin A dosage from 100 to 155 IU following the PREEMPT protocol in patients with chronic migraine

R. Agosti, R. Langner; Zollikon (CH)

11:10–11:20

"Schmerz-Dolmetscher" ("Pain Translator") – Visual representation of pain quality

N. Stemmer-Holtz; Zurich (CH)

11:20–11:30

Subjective and objective sleep quality in migraine: The Hypnolaus/Psycholaus study

J. Haba-Rubio, D. Andries, N. Tobback, M. Preisig, E. Castelao, M. Tafti, R. Heinzer; Lausanne (CH)

11:30–11:40

The effects of short-term CPAP withdrawal on myocardial perfusion in OSA – a randomised placebo-controlled trial

E.I. Schwarz, S. Schlatzer, J. Stehli, P.A. Kaufmann, K.E. Bloch, J.R. Stradling, M. Kohler; Zurich (CH), Oxford (GB)

11:40–11:50

The effect of CPAP withdrawal on blood pressure in patients with OSA: data from three randomised-controlled trials

E.I. Schwarz, C. Schlatzer, V.A. Rossi, C. Nowak, K.E. Bloch, J.R. Stradling, M. Kohler; Zurich (CH), Oxford (GB)

11:50–12:00

Effect of travelling to moderate altitude on sleep, nocturnal breathing and sleep quality in COPD patients

T. D. Latshang, M. Furian, D. Flück, S.D. Segitz, S. Müller-Mottet, B. Osmonov, R.P.M. Tardent, S. Ulrich, M. Kohler, K.E. Bloch; Zurich (CH), Bishkek (KG)

10:30-12:00

Room DC3/Orion

Free Communications SSSSC

Chairs: Hans-Peter Landolt, Zurich

10:30-10:40

Extended light exposure acts differently on young and older participants

V. Gabel, M. Maire, C. Reichert, C. Schmidt, C. Renz, C. Garbazza, C. Cajochen, A.U. Viola; Basel (CH)

10:40-10:50

Sleepiness and performance is disproportionate in patients with Nonorganic Hypersomnia in comparison to patients with Idiopathic Hypersomnia and also to Narcolepsy and Obstructive Sleep Apnoea Syndrome

D. Schreier, W. J.Schmitt, J. Mathis; Bern (CH)

10:50-11:00

Cerebral correlates of vigilance during night time: Impact of sleep pressure level and inter-individual vulnerability

M. Maire, C.F. Reichert, V. Gabel, A.U.Viola, K. Scheffler, M. Klarhöfer, W. Strobel, C. Cajochen, C. Schmidt; Basel (CH)

11:00-11:10

Fronto-parietal expression of mGluR5 correlates with EEG slow oscillations in NREM sleep

S.C. Holst, K. Hefti, A. Baumer, A. Buck, S.M. Ametamey, M. Scheidegger, R. Dürr, E. Seifritz, H-P. Landolt; Zurich (CH)

11:10-11:20

Phosphorylation of MAPK2 and MAPK3 regulates sleep

C. Mikhail, A. Vaucher, M. Tafti; Lausanne (CH)

11:20-11:30

Central and peripheral metabolic changes induced by gamma-hydroxybutyrate

G. Luca, J. Vienne, A. Vaucher, S. Jimenez, M. Tafti; Lausanne (CH)

11:30-11:40

Derivation of Orexinergic neurons from mouse iPS cells

A. Seifinejad, M. Tafti; Lausanne (CH)

11:40-11:50

Association between Sleep and Working Memory: Contributions of Circadian Phase and Inter-individual Differences in Sleep

C.F. Reichert, M. Maire, V. Gabel, A.U. Viola, V. Kolodyazhnyi, W. Strobel, T. Götz, H-P. Landolt, C. Cajochen, C. Schmidt; Port, Basel (CH), Frankfurt am Main (DE), Zurich (CH)

11:50-12:00

An intact SCN is necessary for PER2 changes in the periphery and after sleep deprivation

T. Curie, Y. Emmenegger, P. Franken; Lausanne (CH)

12:30–13:30

Room Coronado

Posterviewing

13:00–13:45

Room DC3/Orion

Electrical Stimulation in Obstructive Sleep Apnoea

Chair: Malcolm Kohler, Zurich

Jörg Steier, London; GB

13:45–14:30

Room DC3/Orion

How to score respiratory polygraphies?

Raphael Heinzer, Lausanne

Yvonne Nussbaumer, Münsterlingen

14:30–15:00

Coffee break

15:00–16:30

Room Coronado

Sleep and cognition

Chairs: Mathias Sturzenegger, Bern; Björn Rasch, Fribourg

15:00–15:30

Sleep, consolidation and semantic memory formation

Penny Lewis, Manchester; GB

15:30–16:00

Stress, memory and sleep

Sandra Ackermann, Zurich

16:00–16:30

Interplay between sleep and memory during early developmental stages

Ines Wilhelm, Zurich

15:00–16:30

Room DC3/Orion

Inflammation in sleep and headache

Chairs: Claudio Gobbi, Lugano; Katerina Espa Cervena, Geneva

15:00–15:45

Sleep and inflammation

Alexandros Vgontzas, Hershey; US

15:45–16:30

Headache and inflammatory white matter lesions

Maria Rocca, Milano; IT

16:30–17:15

Room Coronado

Award ceremony

List of invited speakers and chairs

Page		
12	Prof. Peter Achermann, PhD Universität Zürich Institut für Pharmakologie und Toxikologie Winterthurerstrasse 190 8057 Zürich, CH	13 Andreas Gantenbein, MD RehaClinic Bad Zurzach Neurologie Quellenstrasse 34 5330 Bad Zurzach, CH
18	Sandra Ackermann, PhD University Hospital Zurich Division of Biopsychology Rämistrasse 100 8006 Zürich, CH	18 Claudio Gobbi, MD Ospedale Civico Neurologie Via Tesserete 46 6900 Lugano, CH
15	Prof. Urs Albrecht, PhD University of Fribourg Department of Biology Unit for Biochemistry Chemin du Musée 5 1700 Fribourg, CH	15 José Haba-Rubio, MD Centre hospitalier CHUV Centre d'investigation et de recherche sur le sommeil Rue du Bugnon 46 1011 Lausanne, CH
12, 13	PD Christian Baumann, MD Universitätsspital Zurich Epileptologie, EEG, SEP, AEP, VEP Rämistrasse 100 8091 Zürich, CH	18 PD Raphael Heinzer, MD Centre hospitalier CHUV Centre d'investigation et de recherche sur le sommeil Rue du Bugnon 46 1011 Lausanne, CH
12	Mads Barløse, MD Danish Headache Center Nordre Ringvej 67 2600 Glostrup, DK	15 Philip R. Holland, PhD Kings College London Institute of Psychiatry Dept. Of Clinical Neuroscience 1 Windsor Wlk, Denmark Hill SE85AF London, GB
12	Prof. Konrad E. Bloch, MD University Hospital Zurich Pulmonary Division & Sleep Disorders Center Rämistrasse 100 8091 Zürich, CH	13 PD Jenewein Josef, MD University Hospital Zurich Department of Psychiatry Rämistrasse 100 8091 Zürich, CH
18	Katerina Espa Cervena, MD Hôpital Belle-Idée Service de Neuropsychiatrie Laboratoire du sommeil 2, Chemin Du Petit-Bel-Air 1225 Chêne-Bourg, CH	12 PD Ramin Khatami, MD Klinik Barmelweid Schlafmedizin 5017 Barmelweid, CH
15	Prof. Paul Franken, PhD Center for Integrative Genomics University of Lausanne Genopode Building 1015 Lausanne, CH	18 Prof. Malcolm Kohler, MD UniversitätsSpital Zürich Klinik für Pneumologie Rämistrasse 100 8091 Zürich, CH
15	PD Tobias Freilinger, MD Universitätsklinikum Tübingen Abteilung für Neurologie mit Schwerpunkt Epileptologie Hoppe-Seyler-Strasse 3 72076 Tübingen, DE	17 Prof. Hans-Peter Landolt, PhD Universität Zürich Institut für Pharmakologie und Toxikologie Winterthurerstrasse 190 8057 Zürich, CH

List of invited speakers and chairs

- 18 **Prof. Penny Lewis, MD**
University of Manchester
Neuroscience of Aphasia
Research Unit
Brunswick Street
Manchester, GB
- 15 **Prof. Anita Lüthi, PhD**
Université de Lausanne
Neurosciences fondamentales
Rue du Bugnon 9
1005 Lausanne, CH
- 16 **Prof. Johannes Mathis, MD**
Inselspital Bern
Neurologische Universitätsklinik
Schlaf-Wach-Zentrum
Freiburgstrasse 18
3010 Bern, CH
- 15 **Peter Myers, MD**
7, ruelle du Couchant
1207 Genève, CH
- 12, 18 **Yvonne Nussbaumer, MD**
Kantonsspital Münsterlingen
Pneumologie
Spitalcampus 1
8596 Münsterlingen, CH
- 18 **Prof. Björn Rasch, PhD**
University of Fribourg
Cognitive Biopsychology
Rue P. A. de Faucigny 2
1701 Fribourg, CH
- 18 **Maria A. Rocca, MD**
University Ospedale San Raffaele
Department of Neurology
Milano, IT
- 12 **PD Peter Sandor, MD**
Kantonsspital Baden
Akutnahe Neurorehabilitation
5405 Baden Dättwil, CH
- 12 **Prof. Thomas E. Scammell, MD**
Harvard Medical School
Division of Sleep Medicine
401 Park Drive, 2nd floor East
MA 2215 Boston, US
- 12 **Prof. Jean Schoenen, PhD**
Liège University
Neurobiology Research Center CNCM
CHU-Sart Tilman T4 1+ B36
4000 Liège, BE
- 18 **Jörg Steier, MD, PhD**
King's College London/King's Health Partners
Lane Fox Respiratory Unit/Sleep Disorders Centre
St Thomas' Hospital
Westminster Bridge Road
Guy's & St Thomas' NHS Foundation Trust
London SE1 7EH, GB
- 15, 16 **Prof. Till Sprenger, MD**
Neurologische Klinik und Poliklinik
Universitätsspital Basel
Petersgraben 4
4031 Basel, CH
- 18 **Prof. Mathias Sturzenegger, MD**
Inselspital Bern
Neurologische Universitätsklinik
Freiburgstrasse 18
3010 Bern, CH
- 15 **Prof. Mehdi Tafti, PhD**
Université de Lausanne
Center for Integrative Genomics
Genopode, Dorigny Campus
Route de Blévallaire
1015 Lausanne, CH
- 12 **Philipp Valko, MD**
University Hospital Zurich
Neurology
Frauenklinikstrasse 26
8091 Zürich, CH
- 18 **Prof. Alexandros Vgontzas, MD**
College of Medicine
Dept. Psychiatry
500 University Drive
PA 17033 Hershey, US
- 18 **Ines Wilhelm, PhD**
Universitätskinderhospital Zürich
Steinwiesstrasse 75
8032 Zürich, CH

Posters

- P01 **Targeting inactivation of Hcrt receptors in dopaminergic and noradrenergic neurons alters the EEG spectral profile during wakefulness**
S. Li, A. Vassalli, C. Schrick, P. Franken, M. Tafti; Lausanne (CH)
- P02 **Altered light sensitivity in a mouse model for Smith–Magenis syndrome**
S. Diessler, P. Franken; Lausanne (CH)
- P03 **Light therapy in a sighted man with non-24-hour sleep–wake disorder: a case study**
C. Garbazza, V. Bromundt, U. Lang, D. Brunner, C. Cajochen; Basel, Zollikon (CH)
- P04 **A reappraisal of the central role of Period 2 in circadian rhythms: a knock-out study**
F. La Spada, G. Mang, Y. Emmenegger, C.C. Lee, P. Franken; Lausanne (CH), Huston (US)
- P05 **Automatic artifact detection in long-term EEG recordings**
A. Malafeev, A. Wierzbicka, A. Wichniak, P. Achermann; Zurich (CH), Warsaw (PL)
- P06 **Investigating the role of microRNAs in sleep homeostasis**
G.M. Mang, S. Jimenez, F. Consales-Barras, J. Weber, P. Franken; Lausanne (CH)
- P07 **Neuron-specific deletion of the miRNA-processing enzyme Dicer induces severe but transient obesity in mice**
G.M. Mang, N-H. Du, F. Preitner, L. Wigger, S. Pradervand, D. Gatfield, P. Franken; Lausanne (CH)
- P08 **Vigilance and cortical excitability after acute sleep deprivation and chronic sleep restriction**
A. Maric, C. Lustenberger, J. Leemann, E. Werth, A. Tarnutzer, A. Pangalu, R. Huber, C. Baumann, R. Poryazova; Zurich (CH)
- P09 **The build-up of sleep slow wave activity in young patients with stroke - investigating alterations in the topographical distribution and longitudinal changes in the course of recovery**
A-L. Mouthon, H.J.A. van Hedel, A. Meyer-Heim, R. Huber; Affoltern am Albis, Zurich (CH)
- P10 **Sleep homeostasis in vitro**
S. Saberi-Moghadam, C. Mikhail, M. Tafti; Lausanne (CH)
- P11 **The effect of continuous positive airway pressure therapy on endothelial function in obstructive sleep apnea: a systematic review and meta-analysis**
E.I. Schwarz, M.A. Puhan, C. Schlatzer, J.R. Stradling, M. Kohler; Zurich (CH), Oxford (GB)
- P12 **A role for group-I metabotropic glutamate receptors (mGluR1/5) in sleep-wake regulation?**
A. Sousek, HP. Landolt, P. Franken, M. Tafti; Zurich, Lausanne (CH)
- P13 **Cerebral Blood Flow and Neuronal Oscillations during Sleep are Anti-correlated**
L. Tüshaus, A. Schläpfer, R. O’Gorman, A. Federspiel, R. Luechinger, P. Staempfli, D. Brandeis, Thomas Koenig, P. Achermann; Zurich, Bern (CH), Mannheim (DE)
- P14 **Effects of the COMT inhibitor tolcapone on mood and working memory during sleep deprivation**
A. Valomon, A. Borrello, S.C. Holst, M. Sommerauer, W. Berger, C.R. Baumann, H-P. Landolt, Zurich (CH)

Posters

- P15 **Improving Sleep Quality with Protective Eyewear to Block Short-Wavelength Blue Light in a Patient with Delayed Sleep Phase Disorder – Casereport**
A. Poppel, D. Scholtze, K. Cattapan; Kilchberg, Zurich (CH)
- P16 **Obstructive Sleep Apnea risk, Excessive daytime sleepiness and Sleep Quality in Georgian Population**
N. Darchia, N. Oniani, M. Datunashvili, T. Basishvili, I. Sakhelashvili, M. Eliozishvili, K. Cervena; Tbilisi (GE), Geneva (CH)
- P17 **Predominant endothelial vasomotor activity during human sleep: a near-infrared spectroscopy study**
Z. Zhang, R. Khatami; Barmelweid, Bern (CH)
- P18 **The interaction between thermoregulatory and sleep regulatory systems during sleep characterized by hemodynamic measurements with near-infrared spectroscopy**
Z. Zhang, R. Khatami; Barmelweid, Bern (CH)
- P19 **Prevalence and characteristics of periodic leg movements during sleep in the general population: the Hypnolaus study**
J. Haba-Rubio, H. Marti-Soler, D. Andries, N. Tobback, M. Tafti, R. Heinzer; Lausanne (CH)
- P20 **Optogenetic identification of a rapid-eye-movement (REM) sleep modulatory circuit in the hypothalamus**
S. Jogo, S.D. Glasgow, C. Gutierrez Herrera, R. Boyce, A.R. Adamantidis; Bern (CH), Montreal (CA)
- P21 **Increased sleep need after traumatic brain injury: A comparative behavioural and histological study in rats and humans**
D. Noain, L.L. Imbach, E. Werth, S.R. Schreglmann, P.O. Valko, M. Penner, M. Morawska, T. Li, A. Maric, E. Symeonidou, J. Stover, L. Mica, Y.V. Gavrilov, T.E. Scammell, C.R. Baumann; Zurich (CH), Boston (US)
- P22 **Psychomotor vigilance task demonstrates impaired vigilance in disorders with excessive daytime sleepiness**
J. Thomann, C.R. Baumann, H.-P. Landolt, E. Werth; Zurich (CH)
- P23 **Baclofen facilitates sleep, neuroplasticity and functional recovery after stroke in rats.**
A. Hodor, S. Palchykova, F. Baracchi, D. Noain, C.L. Bassetti; Bern, Zurich (CH)
- P24 **Transcriptome analysis of sleep deprivation associated neuroprotection in a rodent model of stroke**
F. Baracchi, M. Pace, C. Bassetti; Bern (CH)



Gemeinsame Jahrestagung

Schweizerische Gesellschaft für Intensivmedizin
Schweizerische Neurologische Gesellschaft
Schweizerische Gesellschaft für Neuroradiologie
Schweizerische Gesellschaft für Notfall- und Rettungsmedizin
Schweizerische Hirnströgesellschaft

Gäste:

Schweizerische Gesellschaft für Verhaltensneurologie & Schweizerische Liga gegen Epilepsie

Réunion annuelle

Société Suisse de Médecine Intensive
Société Suisse de Neurologie
Société Suisse de Neuroradiologie
Société Suisse de Médecine d'Urgence et de Sauvetage
Société Cérébrovasculaire Suisse

Invités:

Société Suisse de Neurologie Comportementale & Ligue Suisse contre l'Epilepsie

29.-31.10.2014

Congress Centre Kursaal Interlaken
www.imk.ch/sgj2014

Abstract submission
Deadline 13.07.2014



BEI MIGRÄNEANFALL:

- **RASCH**¹
- **ANHALTEND**¹



Wir freuen
uns über
Ihren
Besuch am
Stand Nr. 5

¹ Mathew NT et al. Evaluating the triptans. The American Journal of Medicine 2005; 118: 285-355

Relpax® (Eletriptan). **Indikationen:** Akutbehandlung von Migräneanfällen, mit oder ohne Aura. **Dosierung:** Empfohlene Initialdosis: 40 mg, bei ungenügender Wirkung 80 mg bei nächstem Anfall. Bei Rezidiv innerhalb 24 Stunden: Weitere Dosis derselben Stärke frühestens 2 Stunden nach der ersten Einnahme. Maximale Tagesdosis: 160 mg. **Kontraindikationen:** Überempfindlichkeit gegenüber Eletriptan oder einem der Hilfsstoffe, Niereninsuffizienz, schwere Leberinsuffizienz, unkontrollierte Hypertonie, ischämische Herzkrankheit, koronare Vasospasmen/Prinzmetal-Angina, periphere Gefässerkrankung, cerebrovaskuläre oder transiente ischämische Attacken, gleichzeitige Anwendung von Ergotamin (-derivaten) oder anderen 5HT₁-Rezeptor-Agonisten, hemiplegische Migräne, Basilarismigräne. **Vorsichtsmassnahmen:** Unerkannte kardiale Erkrankung, Risiko einer ischämischen Herzkrankheit, Epilepsie, Überempfindlichkeit gegenüber Azofarbstoffen, Serotonin-Syndrom bei gleichzeitiger Anwendung von anderen Arzneimitteln mit serotonerger Wirkung, arzneimittelinduzierter Dauerkopfschmerz bei übermässiger Anwendung; Schwangerschaft, Stillzeit. **Interaktionen:** Starke Inhibitoren von CYP3A4, Ergotamin, Ergotaminanaloga, andere Arzneimittel mit serotonerger Wirkung. **Unerwünschte Wirkungen:** Asthenie, Müdigkeit, Benommenheit, Übelkeit u.a. **Packungen:** Filmtabletten 40 mg: 4, 6 und 20; Filmtabletten 80 mg: 6 und 20. Abgabekategorie B. **Zulassungsinhaber:** Pfizer AG, Schärenmoosstrasse 99, 8052 Zürich. Ausführliche Informationen siehe Arzneimittel-Fachinformation unter www.swissmedinfo.ch. (FI V007)



66210-221-12/13